

DK-AirCash

Hardware Manual

**Federal Communications Commission
Radio Frequency Interference
Statement**

This device complies with Part 15 of the FCC Rules. Operation is subject to the following two conditions:

- (1) This device may not cause harmful interference, and
- (2) this device must accept any interference received, including interference that may cause undesired operation.

NOTE: This equipment has been tested and found to comply with the limits for a Class A digital device, pursuant to Part 15 of the FCC Rules. These limits are designed to provide reasonable protection against harmful interference when the equipment is operated in a commercial environment. This equipment generates, uses and can radiate radio frequency energy and, if not installed and used in accordance with the instruction manual, may cause harmful interference to radio communications. Operation of this equipment in a residential area is likely to cause harmful interference in which case the user will be required to correct the interference at his own expense.

FCC WARNING

Changes or modifications not expressly approved by the party responsible for compliance could void the user's authority to operate the equipment.

For compliance with the Federal Noise Interference Standard, this equipment requires a shielded cable.

For RF interference suppression, if a ferrite core is provided with this device, affix it to the interface cable.

This statement will be applied only for the printers marketed in U.S.A.

**Statement of
The Canadian Department of Communications
Radio Interference Regulationst**

This Class A digital apparatus complies with Canadian ICES-003.

The above statement applies only to printers marketed in Canada.

Trademark acknowledgments

DK-AirCash: Star Micronics Co., Ltd.

< For Bluetooth models >

**Federal Communications Commission
Radio Frequency Interference
Statement**

This device complies with Part 15 of FCC Rules and Industry Canada licence-exempt RSS standard(s). Operation is subject to the following two conditions:

- (1) this device may not cause interference, and
- (2) this device must accept any interference, including interference that may cause undesired operation of this device.

This equipment complies with FCC/IC radiation exposure limits set forth for an uncontrolled environment and meets the FCC radio frequency (RF) Exposure Guidelines in Supplement C to OET65 and RSS-102 of the IC radio frequency (RF) Exposure rules. This equipment has very low levels of RF energy that it deemed to comply without maximum permissive exposure evaluation(MPE). But it is desirable that it should be installed and operated keeping the radiator at least 20cm or more away from person's body (excluding extremities: hands,wrists,feet and ankles).

Le présent appareil est conforme aux la partie 15 des règles de la FCC et CNR d'Industrie Canada applicables aux appareils radio exempts de licence. L'exploitation est autorisée aux deux conditions suivantes :

- (1) l'appareil ne doit pas produire de brouillage, et
- (2) l'utilisateur de l'appareil doit accepter tout brouillage radioélectrique subi, même si le brouillage est susceptible d'en compromettre le fonctionnement.

Cet équipement est conforme aux limites d'exposition aux rayonnements énoncées pour un environnement non contrôlé et respecte les règles les radioélectriques (RF) de la FCC lignes directrices d'exposition dans le Supplément C à OET65 et d'exposition aux fréquences radioélectriques (RF) CNR-102 de l'IC. Cet équipement émet une énergie RF très faible qui est considérée conforme sans évaluation de l'exposition maximale autorisée. Cependant, cet équipement doit être installé et utilisé en gardant une distance de 20 cm ou plus entre le dispositif rayonnant et le corps (à l'exception des extrémités : mains, poignets, pieds et chevilles).

This statement will be applied only for the printers marketed in U.S.A and Canada.

CE MARKING WARNING

Hereby, Star Micronics Co., Ltd. declares that this device is in compliance with the essential requirements and other relevant provisions of Directive 1999/5/EC.

Notice) This device can be operated in all European countries.

Italy: The public use is subject to general authorisation by the respective service provider.

Norway: This subsection does not apply for the geographical area within a radius of 20 km from the centre of Ny-Alesund.

This statement will be applied only for the printers marketed in Europe.

Notice

- All rights reserved. Reproduction of any part of this manual in any form whatsoever, without STAR's express permission is forbidden.
- The contents of this manual are subject to change without notice.
- All efforts have been made to ensure the accuracy of the contents of this manual at the time of going to press. However, should any errors be detected, STAR would greatly appreciate being informed of them.
- The above notwithstanding, STAR can assume no responsibility for any errors in this manual.

Caution Symbol



This symbol is located near the peripheral drive connector.
Do not connect this to a telephone.

English:	Warning: This is a class A product. In a domestic environment this product may cause radio interference in which case the user may be required to take adequate measures.	Slovensky: [Slovak]	Varovanie: Toto je zariadenie triedy A. V domácom prostredí môže tento produkt spôsobovať rušenie rádiových frekvencií. V takom prípade musí používateľ prijať príslušné opatrenia.
Deutsch: [German]	Warnung: Dies ist ein Produkt der Klasse A. Bei der Verwendung dieses Produkts im Haus- oder Wohnungsbereich kann es zu Funkstörungen kommen. In diesem Fall muss der Benutzer u. U. angemessene Maßnahmen ergreifen.	Slovensko: [Slovenian]	Opozorilo: To je izdelek razreda A. V domačem okolju lahko ta izdelek povzroča motnje radijskih frekvenc, v tem primeru mora uporabnik ustrezno ukrepati.
Svenska: [Swedish]	Varning: Detta är en klass A-product. Denna produkt kan orsaka radiostörningar inomhus. Det kan då vara ett krav att användaren vidtar lämpliga åtgärder.	Česky: [Czech]	VAROVÁNÍ: Toto je produkt třídy A. V domácím prostředí může tento produkt způsobovat rušení rádiových frekvencí, a v takovém případě se od uživatele vyžaduje, aby učinil odpovídající opatření.
Español: [Spanish]	Advertencia: Este es un producto de clase A. En entornos domésticos, este producto puede producir radiointerferencias, en cuyo caso el usuario deberá tomar las medidas oportunas.	Magyar: [Hungarian]	Figyelem: „A” osztályba sorolt termék. Lakóhelyi környezetben ez a termék rádiófrekvenciás (RF) interferenciát okozhat, ebben az esetben a felhasználónak gondoskodnia kell a szükséges ellenintézkedésekről.
Português: [Portuguese]	Aviso: Esse é um produto de Classe A. Em um ambiente doméstico, esse produto pode causar interferência de rádio; nesse caso, o usuário poderá ter de tomar medidas adequadas.	Български: [Bulgarian]	ВНИМАНИЕ: Това е продукт от Клас А. В жилищна среда този продукт може да създаде радиочестотни смущения, в който случай потребителят ще трябва да вземе съответните мерки.
Français: [French]	Avertissement: Cet appareil est un produit de classe A. Dans un environnement domestique, ce produit peut générer des interférences radioélectriques, auquel cas l'utilisateur devra prendre des mesures appropriées.	Polski: [Polish]	OSTRZEŻENIE: Urządzenie to jest urządzeniem klasy A. W warunkach domowych urządzenie to może wywoływać zakłócenia o częstotliwości radiowej, wymagające od użytkownika podjęcia odpowiednich działań zaradczych.
Suomi: [Finnish]	Varoitus: Tämä on A-luokan tuote. Kotona käytettynä tämä tuote voi aiheuttaa radiotaajuushäiriöitä, jolloin käyttäjän tulisi ryhtyä vaadittaviin toimenpiteisiin häiriöiden ehkäisemiseksi.	Malti: [Maltese]	OSTRZEŻENIE: Urządzenie to jest urządzeniem klasy A. W warunkach domowych urządzenie to może wywoływać zakłócenia o częstotliwości radiowej, wymagające od użytkownika podjęcia odpowiednich działań zaradczych.
Italiano: [Italian]	Avvertenza: Prodotto di classe A. È possibile che il prodotto generi interferenze radio in un ambiente chiuso. In questo caso l'utente deve intraprendere le misure adeguate per risolvere il problema.	Latviski: [Latvian]	BRĪDINĀJUMS: Šis A klases izstrādājums. Izmantojot šo izstrādājumu mājās apstākļos, tas var radīt radiotraucējumus; šajā gadījumā lietotājam var būt nepieciešams veikt atbilstošus pasākumus.
Dansk: [Danish]	ADVARSEL: I et hjemligt miljø kunne dette produkt forårsage radio forstyrrelse. Bliver det tilfældet, påkræves brugeren muligvis at tage tilstrækkelige foranstaltninger.	Lietuvių : [Lithuanian]	ĮSPĖJIMAS: Tai yra A klasės produktas. Gyvenamosiose aplinkose šis produktas gali kelti radijo dažnių trikdžius. Tokiu atveju naudotojui gali reikėti imtis atitinkamų priemonių.
Nederlands: [Dutch]	Waarschuwing: Dit is een product van klasse A. In een woonomgeving kan dit product radiostoring veroorzaken. In dat geval moet de gebruiker de juiste maatregelen nemen.	Român: [România]	Avertisment: Acesta este un produs din Clasa A. În mediul casnic, acest produs poate cauza interferențe radio, caz în care utilizatorul trebuie să ia măsurile necesare.
Eesti: [Estonian]	Avertissement: Ce produit est un produit de classe A. Dans un environnement résidentiel, ce produit peut provoquer des perturbations radioélectriques, auquel cas l'utilisateur peut se voir obligé de prendre les mesures appropriées.		
Ελληνική: [Greek]	ΠΡΟΕΙΔΟΠΟΙΗΣΗ: Αυτό είναι ένα προϊόν κατηγορίας Α. Σε οικιακό περιβάλλον, αυτό το προϊόν μπορεί να προκαλέσει παρεμβολές ραδιοσυχνότητας (RF), στην οποία περίπτωση μπορεί να απαιτηθεί η λήψη κατάλληλων μέτρων από τον χρήστη.		

TABLE OF CONTENTS

1. Unpacking and Installation	6
1-1. Unpacking	6
1-2. Installation Notes.....	6
2. Parts Identification and Nomenclature	7
3. Setup.....	8
3-1. Connecting to Peripheral Devices	8
3-2. Connecting the Ethernet Interface Cable (When Using a Wired LAN Model).....	8
3-3. Bluetooth Settings (For Bluetooth Models only).....	9
3-4. Connecting the Power Cable.....	10
3-5. Turning the Power On and Off.....	11
3-6. Setup Precautions.....	12
4. LED Setup	14
4-1. POWER and ERROR Lamps Indicators	14
4-2. PAIR Lamp Indicator.....	14

1. Unpacking and Installation

1-1. Unpacking

After unpacking, check that all the necessary accessories are included in the package.

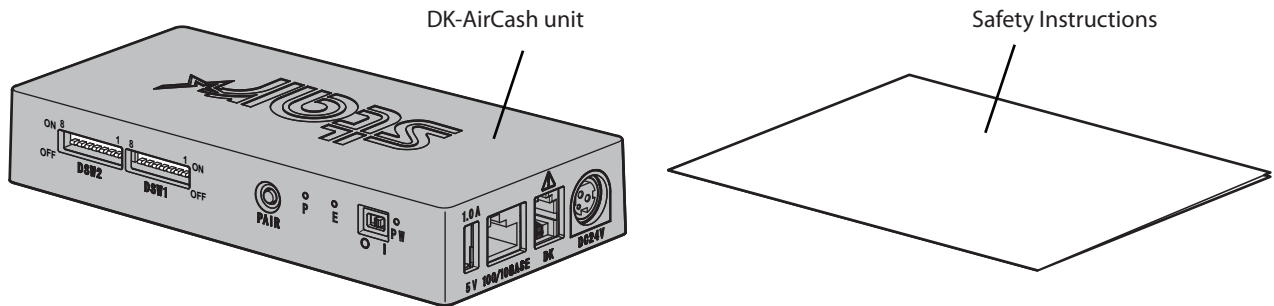

1-2. Installation Notes

1. Locate the DK-AirCash near a power outlet so that the power cable can be easily accessed when needed.
2. Do not use the same outlet that is already being used by copiers, refrigerators, or other devices that generate electrical noise.
3. Do not install in locations exposed to direct sunlight.
4. Do not install in locations near an open flame or where hot air can build up.
5. Do not install in locations with poor ventilation or exposed to large amounts of dust.
6. Do not install in locations exposed to high levels of humidity.
7. Use the DK-AirCash within the operation range specified in the environmental requirements. Even if the ambient temperature and humidity are within the specifications, avoid exposure to extreme changes in environmental conditions. The temperature range for proper operation of the DK-AirCash is shown below.
Operating temperature: 0°C to 45°C
8. Follow your local laws and regulations when disposing of the terminal.

2. Parts Identification and Nomenclature

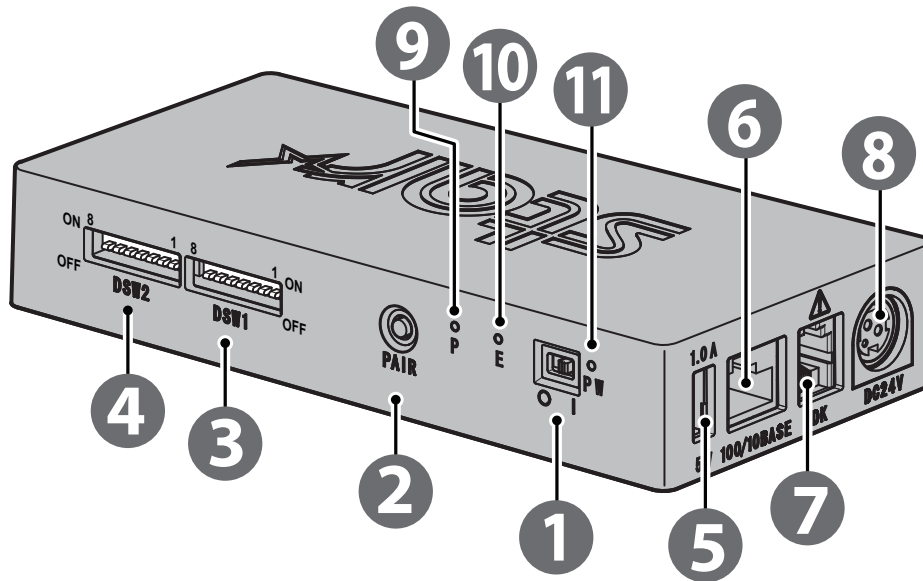

1	Power switch	Turn the DK-AirCash on or off.
2	PAIR button *1	The full color LED indicates the status of the DK-AirCash and any errors that occur.
3	DSW1 (DIP switch1)	The basic settings of the product. Please follow the instructions in this manual to change the settings.
4	DSW2 (DIP switch2)	
5	Power supply connector (USB Type A)*2	Connects to USB devices.
6	Ethernet connector	Connects to a host device using an Ethernet cable.
7	Drawer kick connector	Connects to peripheral devices such as cash drawers.
8	Power connector	Connects to an optional AC adapter (Option).
9	PAIR lamp *1	The green or blue light indicates the status of Bluetooth connection when using the Bluetooth model.
10	ERROR lamp (Red)	This lamp also indicates errors, in combination with POWER lamp.
11	POWER lamp (Green)	The green lamp lights up when the power is turned on. Also, this lamp also indicates errors, in combination with ERROR lamp.

*1 For Bluetooth models only.

*2 The USB type A connector output for this product is designed for 5V 1.0A(maximum). Be sure to use the rated range.

3. Setup

3-1. Connecting to Peripheral Devices

Use the drawer kick connector to connect the DK-AirCash to a cash drawer or other device.

To connect the cable, follow the procedure given below.

- ① Make sure that the AC adapter's power cord is not connected to the outlet.
- ② Connect the cable connector of the cash drawer or other device to the drawer kick connector on the rear of the DK-AirCash.

Note: Do not connect a telephone line to the drawer kick connector. Doing so can cause this product to malfunction. Also, for safety reasons, do not connect a wire that can carry excessive voltage to the drawer kick connector.

3-2. Connecting the Ethernet Interface Cable (When Using a Wired LAN Model)

Note: Make sure the Dip switch 1-1 is on.

- ① Make sure that the AC adapter's power cord is not connected to the outlet.
- ② Insert the Ethernet cable plug into the Ethernet connector.

■ Link disconnection detection feature

The Ethernet interface model is equipped with a link disconnection detection feature.

If the printer is turned on when an Ethernet cable is not connected to it, the POWER and ERROR lamps are simultaneously turned on and off at 4-second intervals to indicate the disconnection. Be sure to connect the Ethernet cable from a PC or hub to the printer, and then turn the printer on.

If the IP address is not recognized correctly, the POWER and ERROR lights continue to flash simultaneously every 0.25 seconds indicating that the link is broken. After setting the correct IP address, restart the printer.

3-2-1. Resetting Ethernet Settings

The IP Address, Administrator login pass word, and other settings can be reset by following the procedure given below.

- ① Make sure that the AC adapter's power cord is not connected to the outlet.
- ② Unplug the Ethernet cable from the Ethernet connector.
- ③ DSW1-4 Off, connect the AC adapter, turn the power On.
- ④ When initialization is finished, the DK-AirCash's POWER and ERROR lamps flashes.
- ⑤ Turn the power Off, unplug the AC adapter's power code, DSW1-4 On.
- ⑥ Connect the power cord according to the procedure in section 3-4 "Connecting the AC Adapter".

Note) Factory Settings

Administrator login user name / pass word	root / public
IP Address	0.0.0.0
Sub-net Mask	0.0.0.0
Default Gateway	0.0.0.0
DHCP Client	Enable

3-3. Bluetooth Settings (For Bluetooth Models only)

Pair the printer with the master device by following the procedure below.

Note1: Make sure the Dip switch 1-1 is on.

2: Please pay attention to your external environments to secure the pairing of DK-AirCash with the specified master device.

3-3-1. Pairing using SSP (Simple Secure Pairing) [Default]

- ① After turning the DK-AirCash's power switch on, press and hold the PAIR button for 5 seconds or more, and then release it. The LED will flash green.
- ② Pairing will be possible for 60 seconds from when the LED begins flashing green. During this time, perform pairing from the master device.
Device name: Star Micronics (default)
- ③ After performing pairing, wait until the LED stops flashing blue, or turn the DK-AirCash off and back on again, to enable the connection. With some master devices, after pairing, the LED will automatically begin flashing blue, and the printer will be automatically connected.
- ④ Confirm the connection by operating from the master device application.

3-3-2. Pairing using PIN code

Enter the following information in the master device if it does not support SSP, or when otherwise necessary.

PIN Code: 1234 (default)

Device name: Star Micronics (default)

Note: It is recommended that you change the PIN code for greater security.

Use the exclusive setting utility to the PIN code settings.

For more information about setting utility, refer to the following website.

<http://www.star-m.jp/eng/dl/dl02.htm>

3-3-3. Resetting Bluetooth Settings

The PIN code, device name, and other settings can be reset by following the procedure given below.

- ① Make sure that the AC adapter's power cord is not connected to the outlet.
- ② DSW1-3 Off, connect the AC adapter, turn the power On.
- ③ When the initialization starts, the DK-AirCash's POWER and ERROR lamps flashes.
- ④ When initialization is finished, the POWER and ERROR lamps stops flashing.
- ⑤ Turn the power Off, unplug the AC adapter's power code, DSW1-3 On.
- ⑥ Delete the pairing settings of the paired device.
- ⑦ Restart the paired device or terminate the application.
- ⑧ Connect the power cord according to the procedure in section 3-4 "Connecting the AC Adapter", turn the power On again and establish pairing connection.

3-4. Connecting the Power Cable

Note: Before connecting or disconnecting the power cable, make sure that the DK-AirCash and all the devices connected to it are turned off.

- ① Connect the AC adapter to the power cord.
- ② Connect the AC adapter to the connector on the device.
- ③ Insert the power cable plug into an AC outlet.

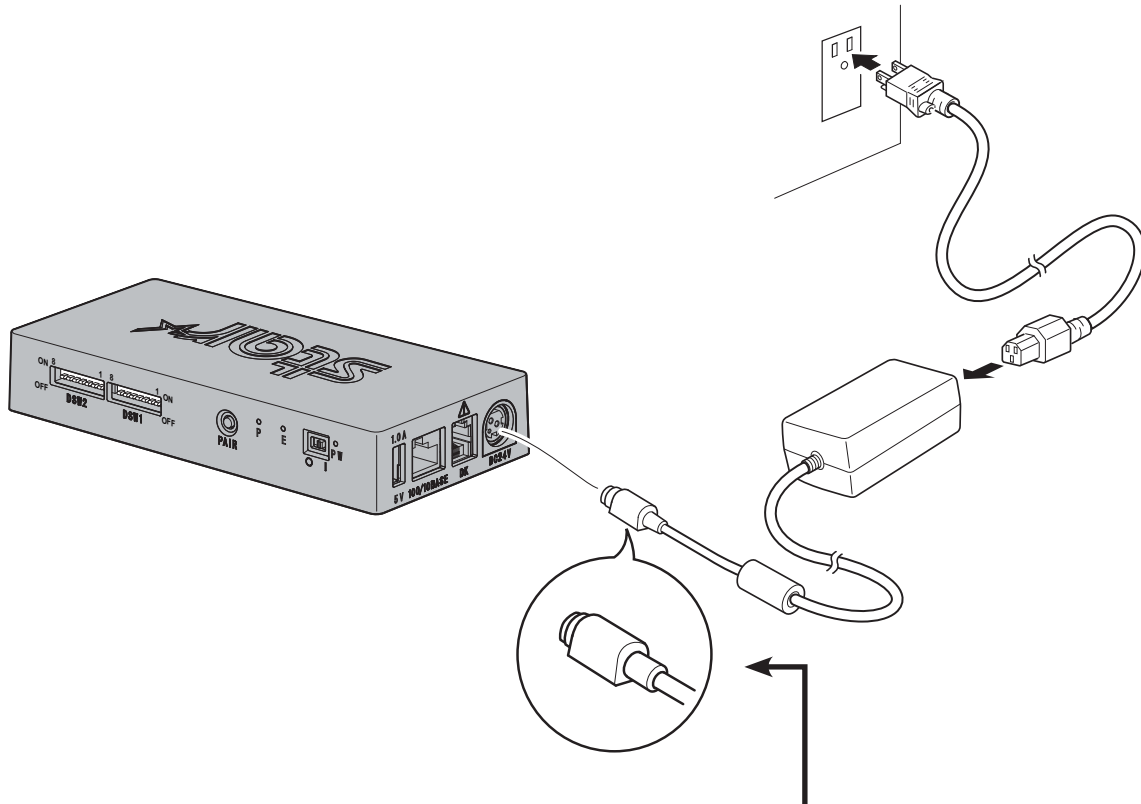

CAUTION

When disconnecting the cable, take hold of the cable connector to pull it out. Releasing the lock makes it easy to disconnect the connector.

Pulling the cable excessively could cause damage to the connector.

Note: We recommend that you use the standard AC adapter and power cord.

If you are not using the optional AC adapter (PS60A-24B1 series) and are instead preparing your own power supply, note the following points.

- Use a power supply that is 24 VDC \pm 10% and 0.7 A or more.
- Use a power supply that supports with SELV output and LPS (Limited Power Source).
- Take into consideration the noise in the environment that the printer is installed in, and take appropriate measures to protect the printer from static electricity, AC line noise, etc.

3-5. Turning the Power On and Off

- ① Follow the procedure in section 3-4, "Connecting the Power Cable" to connect the power cable.
- ② Turn on the Power switch on the front of the DK-AirCash.
The green lamp lights up when the power is turned on.

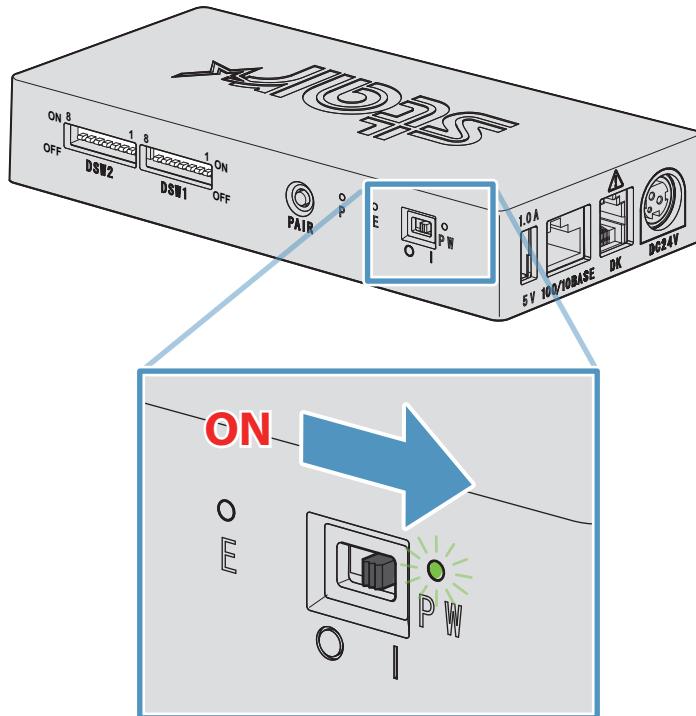

3-6. Setup Precautions

WARNING

- ✓ If you notice smoke or strange odors coming from this product, turn off the power immediately, and unplug the power cable from the AC outlet. For repairs, contact the dealer where you purchased the product.
- ✓ Never attempt to repair the product yourself. Doing so can be dangerous.
- ✓ Never try to disassemble, modify, or repair the product yourself. Doing so can result in an injury, fire, or electric shock.
- ✓ If liquid or foreign objects enter the inside of the product, turn the power switch off, disconnect the power cord from the AC outlet, and consult the dealer that you bought the product from.
Continuing to use the product may lead to a short-circuit, which may cause electric shock or fire.

CAUTION

- ✓ We recommend that you unplug the product from the AC outlet if the product will not be used for a prolonged period.
- ✓ Do not connect a telephone line to the peripheral drive connector, which is used for devices such as cash drawers. Doing so can cause the product to malfunction. Also, for safety reasons, do not connect a wire that may carry excessive voltage to the peripheral drive connector.
- ✓ Make sure that the surrounding area is clean, dry, and free of dust.
- ✓ Make sure that the product is not exposed to direct sunlight.
- ✓ Do not place heavy objects on top of this product. Never stand or lean on this product. Equipment may fall or collapse, causing breakage and possible injury.
- ✓ Do not use this product near the device generating electric noises.
- ✓ Hold the plug when pulling out the cable.
- ✓ Do not put heavy objects on the cable, and bend it heavily.

CAUTION

Wireless Communication

- Do not use the device where using wireless devices is prohibited or may cause interference or danger.
- The radio waves generated by the device may interfere with the operation of electronic medical devices. If you are using any electrical medical device, contact its manufacturer for the restrictions on the use of the device.
- Security functionality for Bluetooth is installed in this product. Configure the security settings according to the manual (available on the Star Micronics website) to reduce the risk of security issues.
- This device supports Bluetooth.
Since this functionality may be limited by local regulations, first review the radio laws specific to the country in which the product will be used.
- Below is a list of laws this device has been approved by. As Star Micronics is committed to constant innovation, revisions may be made without an announcement. Access the Star Micronics website for the latest listing of approvals.
- Please refer to Star Micronics website for the latest information and manuals.

Wireless Communication Security

Via wireless communication, radio waves may be transmitted through obstacles. If your wireless communication is not secured, unauthorized users could access your communication and obtain transmitted information.

This product is equipped with the Bluetooth security function. To reduce security risks, be sure to make security settings according to the manual. Star will not have liability for any damages resulting from security problems including information leakage and unauthorized intrusions which are caused by a lack of appropriate security settings or unavoidable circumstances due to the Bluetooth specifications.

4. LED Setup

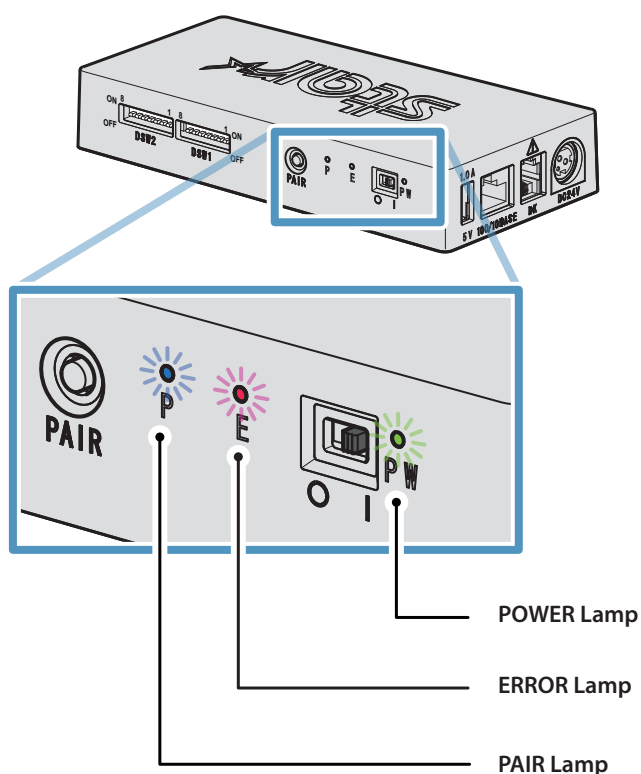

4-1. POWER and ERROR Lamps Indicators

Condition	POWER Lamp	ERROR Lamp	Cause	Recovery condition
Flash error	Off	Flashes at 1 second intervals	Flash memory access error	-
RAM error	Off	Flashes at 2 second intervals	RAM access error	-
Disconnection detection (Physical link disconnection)	Flashes at 4 second intervals	Flashes at 4 second intervals	Physical disconnection (Unplugged LAN cable)	Check the LAN cable connection between the product and hub, and turn the power On again.
Ethernet link disconnection detection (IP address lost)	Flashes at 0.25 second intervals	Flashes at 0.25 second intervals	No IP address was acquired.	Check the IP address settings, and turn the power On again.
Bluetooth initialization	Flashes at 0.25 second intervals	Flashes at 0.25 second intervals	Bluetooth initialization	The product recovers automatically when initialize finished.

4-2. PAIR Lamp Indicator

PAIR Lamp	Condition
Lights up green	The printer is disconnected and in the idle state.
Flashes green	The printer is in the pairing idle state.
Lights up blue	The printer is connected.

English:	Hereby, STAR MICRONICS CO.,LTD. declares that this Wireless Device is in compliance with the essential requirements and other relevant provisions of Directive 1999/5/EC.	Eesti: [Estonian]	Käesolevaga kinnitab STAR MICRONICS CO.,LTD. seadme Wireless Device vastavust direktiivi 1999/5/EÜ põhinõuetele ja nimetatud direktiivist tulenevatele teistele asjakohastele sä tetele.
Deutsch: [German]	Hiermit erklärt STAR MICRONICS CO.,LTD., dass sich das Gerät Wireless Device in Übereinstimmung mit den grundlegenden Anforderungen und den übrigen einschlägigen Bestimmungen der Richtlinie 1999/5/EG befindet.	Ελληνική: [Greek]	ΠΡΟΕΙΔΟΠΟΙΗΣΗ: ΜΕ ΤΗΝ ΠΑΡΟΥΣΑ STAR MICRONICS CO.,LTD. ΔΗΛΩΝΕΙ ΟΤΙ Wireless Device ΣΥΜΜΟΡΦΩΝΕΤΑΙ ΠΡΟΣ ΤΙΣ ΟΥΣΙΩΔΕΙΣ ΑΠΑΙΤΗΣΕΙΣ ΚΑΙ ΤΙΣ ΛΟΙΠΕΣ ΣΧΕΤΙΚΕΣ ΔΙΑΤΑΞΕΙΣ Τ ΗΣ ΟΔΗΓΙΑΣ 1999/5/ΕΚ.
Svenska: [Swedish]	Härmed intygar STAR MICRONICS CO.,LTD. att denna Wireless Device står i överensstämmelse med de väsentliga egenskapskrav och övriga relevanta bestämmelser som framgår av direktiv 1999/5/EG.	Slovensky: [Slovak]	STAR MICRONICS CO.,LTD. týmto vyhlasuje, že Wireless Device spĺňa základné požiadavky a všetky príslušné ustanovenia Smernice 1999/5/ES.
Español: [Spanish]	Por medio de la presente STAR MICRONICS CO.,LTD. declara que el Wireless Device cumple con los requisitos esenciales y cualesquiera otras disposiciones aplicables o exigibles de la Directiva 1999/5/CE.	Slovensko: [Slovenian]	STAR MICRONICS CO.,LTD. izjavlja, da je ta Wireless Device v skladu z bistvenimi zahtevami in ostalimi relevantnimi določili direktive 1999/5/ES.
Português: [Portuguese]	STAR MICRONICS CO.,LTD. declara que este Wireless Device está conforme com os requisitos essenciais e outras disposições da Directiva 1999/5/CE.	Česky: [Czech]	STAR MICRONICS CO.,LTD. tímto prohlašuje, že tento Wireless Device je ve shodě se základními požadavky a dalšími příslušnými ustanoveními směrnice 1999/5/ES.
Français: [French]	Par la présente STAR MICRONICS CO.,LTD. déclare que l'appareil Wireless Device est conforme aux exigences essentielles et aux autres dispositions pertinentes de la directive 1999/5/CE.	Magyar: [Hungarian]	Alulírott, STAR MICRONICS CO.,LTD. nyilatkozom, hogy a Wireless Device megfelel a vonatkozó alapvető követelményeknek és az 1999/5/EC irányelv egyéb előírásainak.
Suomi: [Finnish]	STAR MICRONICS CO.,LTD. vakuuttaa täten että Wireless Device tyyppinen laite on direktiivin 1999/5/EY oleellisten vaatimusten ja sitä koskevien direktiivin muiden ehtojen mukainen.	Български: [Bulgarian]	това Безжично устройство е в съответствие със задължителните изисквания и другите приложими разпоредби на Директива 1999/5/EC.
Italiano: [Italian]	Con la presente STAR MICRONICS CO.,LTD. dichiara che questo Wireless Device è conforme ai requisiti essenziali ed alle altre disposizioni pertinenti stabilite dalla direttiva 1999/5/CE.	Polski: [Polish]	Niniejszym STAR MICRONICS CO.,LTD. oświadcza, że Wireless Device jest zgodny z zasadniczymi wymogami oraz pozostałymi stosownymi postanowieniami Dyrektywy 1999/5/EC.
Dansk: [Danish]	Undertegnede STAR MICRONICS CO.,LTD. erklærer herved, at følgende udstyr Wireless Device overholder de væsentlige krav og øvrige relevante krav i direktiv 1999/5/EF.	Malta: [Maltese]	Hawnhekk, STAR MICRONICS CO.,LTD., jiddikjara li dan Wireless Device jikkonforma mal-ħtiġijiet essenzjali u ma provvedimenti oħrajn relevanti li hemm fid-Dirrettiva 1999/5/EC.
Nederlands: [Dutch]	Hierbij verklaart STAR MICRONICS CO.,LTD. dat het toestel Wireless Device in overeenstemming is met de essentiële eisen en de andere relevante bepalingen van richtlijn 1999/5/EG.	Latviski: [Latvian]	Ar šo STAR MICRONICS CO.,LTD. deklarē, ka Wireless Device atbilst Direktīvas 1999/5/EK būtiskajām prasībām un citiem ar to saistītajiem noteikumiem.
		Lietuvių : [Lithuanian]	Šiuo STAR MICRONICS CO.,LTD. deklaruoja, kad šis Wireless Device atitinka esminius reikalavimus ir kitas 1999/5/EB Direktyvos nuostatas.

Declaration of Conformity

Application of Council Directive(s)

1999/5/EC of 9 Mar 1999

2011/65/EU of 8 Jun 2011

Standard(s) to which Conformity is Declared

RADIO : **EN 300 328 V1.7.1**
EN 50371 : 2002
EMISSION : **EN 301 489-1 V1.9.2**
EN 301 489-17 V2.1.1
EN 55022 : 2010
EN 61000-3-2 : 2006 / +A1 +A2 : 2009
EN 61000-3-3 : 2008
IMMUNITY : **EN 55024 : 2010**
ENVIRONMENT: **EN 50581: 2012**

Manufacturer's Name **Star Micronics Co.,Ltd.**
Manufacturer's Address **20-10 Nakayoshida, Suruga-ku, Shizuoka-shi,
Shizuoka 422-8654 Japan**

Importer's Name **Star Micronics Europe Ltd.**
Importer's Address **Star House, Peregrine Business Park, Gomm Road,
High Wycombe, Bucks. HP13 7DL, U.K.**

Type of Equipment **Peripheral Controller**
Model Name **A004**
Ref. Radio Report No. **F092137E3**
Ref. EMC Report No. **F092137E4 , 89-017-02-EMC**
Ref. Environ. Report No. **A004-RoHS-01**

I , the undersigned , hereby declare that the equipment specified above conforms to the above Directive(s) and Standard(s).

Place High Wycombe - U.K.  (Signature)

Date Jun. 25 , 2013 David Pearce (Full Name)

Year of 1st CE mark '13 Technical Manager (Position)



URL: <http://www.starmicronics.com/support/>