

ITEM NO.	QTY.	PART NUMBER	DESCRIPTION
1	1	M021P660	EXTRUDED POLE CLAMP, BACK, 2"X1.1"
2	1	M021P659	EXTRUDED POLE CLAMP,FRNT, 2"X1.1"
3	2	H5/16-18X3/4SHCSSS	5/16-18 x 3/4 SOCKET HEAD CAP SCREW S/S
4	1	H1/4XSAHKZ	1/4 SA HEX KEY ZINC

REVISIONS		DATE	APPROVED
ZONE	REV.	DESCRIPTION	

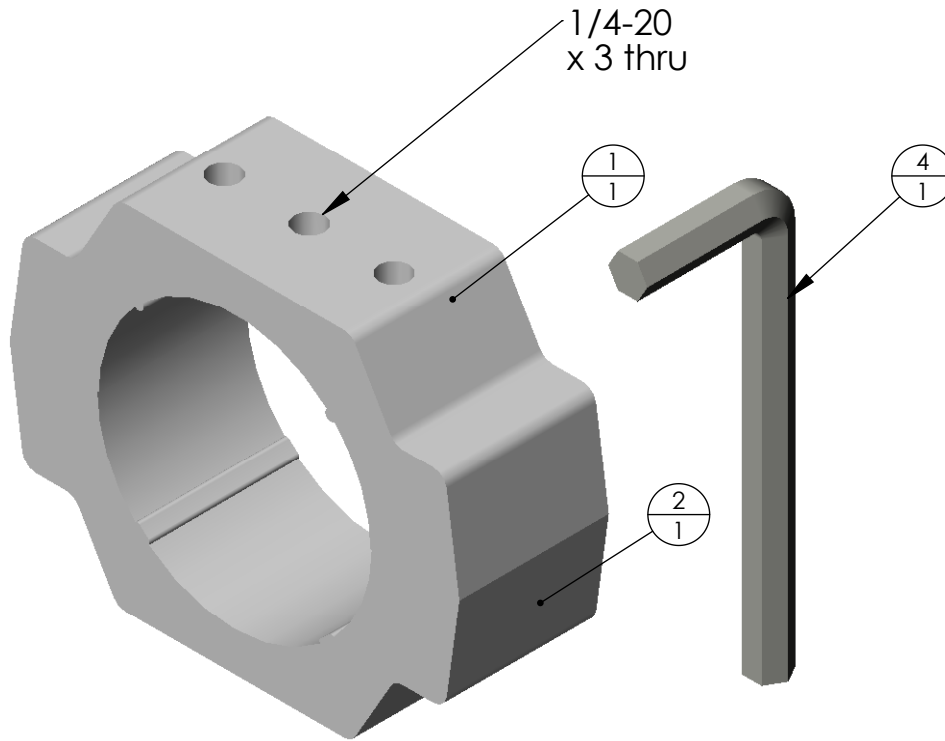

**PROPRIETARY AND CONFIDENTIAL**  
 THE INFORMATION CONTAINED IN THIS DRAWING IS THE SOLE PROPERTY OF ICW USA,Com,Inc ANY REPRODUCTION IN PART OR AS A WHOLE WITHOUT THE WRITTEN PERMISSION OF ICW USA,Com,Inc IS PROHIBITED.

		DIMENSIONS ARE IN INCHES		NAME		DATE	
		TOLERANCES:		DRAWN		11/13/06	
		FRACTIONAL		CHECKED			
		ANGULAR: MACH BEND		ENG APPR.			
		TWO PLACE DECIMAL 0.010		MFG APPR.			
		THREE PLACE DECIMAL 0.005		Q.A.			
		MATERIAL		COMMENTS:			
NEXT ASSY		USED ON		FINISH		--	
APPLICATION		DO NOT SCALE DRAWING					
<b>ICWUSA.Com, Inc</b> 1487 Kingsley Dr. Medford, OR 97504 (541) 608-2824 Fax (541) 608-2797							
DESCRIPTION: <b>2"X1.1" POLE MOUNT MODULE</b>							
SIZE	DWG. NO.	P2X1				REV.	-
<b>A</b>							
SCALE:1:2		WEIGHT:				SHEET 1 OF 1	